

**“Keep close to Nature's heart... and break clear away, once in a while, and climb a mountain or spend a week in the woods. Wash your spirit clean.”**

**John Muir**

***Enjoy over “Seventy Seven” items to create your Incredible Edible Landscape starting today!***

- I. Water Filter & Revitalizer (#1 for a reason)
- II. Raised Vegetable Bed Design
- III. Teeple Living Walls Roofs & Dwellings
- IV. Food Forests & Food
- V. Permaculture Hideout & Garden Art
- VI. Barrels & Containers of Fun
- VII. Consultation, Designs & Surveys
- VIII. Maintenance & Care
- IX. Rawfood Vegan Food Prep
- X. Music & The Quantum Hitch-hikers
- XI. Raw Living Vegan Culinary
- XII. X. Live Garden Party Music
- XIII. XI. Your Brain On Nature

**This Menu titled The Incredible Edible Landscape Menu is to be only used in part or whole, with the written consent of its creator - Tommy Teeple. 5% Minimum finder fee to TT on all work selected from menu...**

**Intellectual Property**

**www.edbl.net    310.924.1839**

A Dedication to Nature, her purity  
preservation protection & what ever  
created life itself.

A life collection of projects,  
installations, creativity & more  
stemming from Local & Luvly values  
of:

Local living

Food production

Home schooling

Local economies

Local entertainment

Local everything

Enjoy,

Tommy Teeple

Create Your Dream Landscape & "Outdoor" cozy life!

**AS ONE WAY OF LIVING  
COMES TO AN END**



**A NEW ONE BEGINS...**

**Simply, what will your natural  
environment look like?  
How can we assist you?  
Select one menu item at a time  
for your beautiful environment...**





# What Is On The Menu?

## **I. Water Filter & Revitalizer (#1 for a reason- water is your first priority)**

A1 - Home Water Filter

A2 - Water Revitalizer

## **II. Raised Vegetable Bed Design**

B1 – Star Gate Gardening

B2 – Cabin Garden

B3 – Twin Cab Garden

B4 – Salad A Day Garden Box

B5 – Salad A Garden Porch Box

B6 – Garden Vegetable Box – Formal

B7 – All In One Vegetable Garden Food Forest

B8 – All In One Vegetable Garden #II

B9 – The Rustic One (vegetable Garden)

B10 – Formal Cucumber Cabinet

B11 – Living Wall Raised Vegetable Beds

B12 – Keyhole Garden

B13 – Mosaic Gardens

## **III. Teeple Living Walls Roofs & Dwelling**

C1 – Steeple Cubby Room

C2 – Teeple Waterfall Cabin

C3 – Teeple Apache

C4 – Mirror Cabin

C5 – Geodesic Dome Cob Home

C6 – Pyramid Home In Nature

C7 – Hobbit Home That Suits Amy

C8 – Underground Dwelling

C9 – Maitreya Mountain Village Hobbit Home

C10 – Teeple Wall

C11 – Tortoise Teeple

C12 – Living Roof Tool Shed

C13 – Baby Teeple Tool Shed

C14 – Vertical Living Wall Cabinet

C15 – Archie Underground Bunker

C16 – Pavilion Tipi

C17 – Cob Bench Hangout

C18 – Succulent Living Wall

## **IV. Food Forest & Food**

D1 – Food Forest

D2 – 7,777 Tree Planting

D3 – Mini Food Forest

D4 – Fruit Trees

D5 – Bed of Basil “FROM SEED”

D6 – Edible Flower Garden

D7 – Passionate Passion Fruit Fence

## **V. Permaculture Hideout**

E1 – Living Roof Edible Garden Sanctuary

E2 – The Village Look

E3 – Formal Food Forest

E4 – Fairy Tunnel Trellis

E5 – Circular Sauna

E6 – Lady’s & Gentlemen “The Doors”

E7 – Permaculture Natural Playgrounds

E8 – Swing

E9 – Dan’s Solarium Mother Green House (HUGE)

E10 – Green House

E11 – Out House Composting Toilet

E12 – Drought Tolerant Island

E13 – Gray Water Outdoor Kitchen

E14 – Drought Tolerant Succulent Buddha Gardening

E15 – Native Plant Restoration

E16 – Living Garden Table

E17 – Living Wall Verdura Block

E18 – Dani’s Artistic River Rock Wall

E19 – Garden Room Malibu Retreat

E20 – Topanga Tommy Teeple (14) Steps

E21 – Creek – Your Own

E22 – Natural Swimming Pool

E23 – Sliding Living Roof Composter

E24 – Simple Composter

E25 – Old School - Rink Of The North

E26 – Figure Skating Rink Of Curves

## **VI. Barrells & Containers Of Fun**

F1 – Tomato Barrel

F2 – Ceramic Container

F3 – Twin Decorative Cement Containers

F4 – Blew’s Blueberry Mini Tower Boxes

## **VII. Consultations & Designing**

G1 – Garden Coaching Consultation

G2 – Permaculture Consultation

G3 – Property Survey

G4 – Theme & Concepts Drawing

G5 – Water Flow Retention Design

G6 – Plant & Landscape Design

G7 – Irrigation Design

G8 – CAD Drawings & Designs

## **IX. Maintenance & Care**

H1 – Fruit Tree Biodynamic Injections

H2 – Tree Transplanting

H3 – Biodynamic Compost

H4 – Soil, Organic Panda Mic. Mulch

H5 – Maintenance & Harvesting

## **IX. Raw Living Vegan Culinary**

## **X. Live Garden Party Music**

## **XI. Your Brain On Nat**

# Water Filter & Revitalizers

## Home Water Filter

(filters all water outlets)



**Name:** Home Water Filter

**Price:** \$4,490.00

**Description:**

- (1) Home Filter
- (2) 1 Delivery
- (3) 1 Installation to main inlet of Home

**Menu #** A1

**Quantity:**

**Maintenance:** Filter change based on usage

# Water Revitalizer



(vortexes all water outlets)

**Name:** Water Revitalizer

**Price:** \$1,500.00

**Description:**

(1) Water Revitalizer

(2) 1 Delivery

(3) 1 Installation to main inlet of Home

**Menu # A2**

**Quantity:**

**Note:** Recommended to watch educational video on water in nature to understand how it works. Simply mimicking nature.

# **Raised Vegetable Bed** **Design**





# Star Gate Garden



**Name:** Star Gate Garden

**Price:** \$70,000.00 + or –

**Description:** See video [www.edbl.net](http://www.edbl.net) - YouTube

- (4) Start Gate circular sliding door 7k
- (5) Arch door 4k
- (6) (4) large beds 20k
- (7) Perimeter raised beds along fence 2k
- (8) Leveling of soil, retaining walls 6k
- (9) (1) canopy 46 x 46 2k
- (10) (10) yrds decorative mulch 2k
- (11) (200'LF) split path 12k
- (12) (1) 184' LF Fence Rustic Recycled Doug Fir 12k
- (13) Chandelier 1k
- (14) Lighting 3k

## **(15) Picnic Table & Benches 4k**

**Menu #B1**

**Quantity:**

**Maintenance: \$600/monthly seasonal check list**

**Water: Deep soak three times per week, Irrigation recommended**

**Prefab: No**

**Work hours: 3months**

**Options: Food forest on perimeter, paths leading in and out.**

**Note:**













# Cabin Garden



**Name:** Cabin Garden

**Price:** \$13,000.00

**Description:** Custom crafted from recycled Douglas fir

- (1) Arch door way 1k
- (2) (2) raised beds 2' x 10' x 18" 7k
- (3) (1) peak 2k
- (4) (4) walls 2k
- (5) (1) irrigation over head mimicking rain 1k

**Menu #B2**

**Quantity:**

**Maintenance:** \$400/monthly & seasonal check list

**Water:** Deep soak three times per week, Irrigation recommended



**Prefab: No**

**Work hours: 1 month**

**Options: Food forest on perimeter, paths leading in and out.**

**Note: Cabin is animal protected top, sides, bottom, sealed (non-toxic), fully planted, irrigated with timer, & mulched**



# Twin Cab Gardens



**Name:** Twin Cab Gardens

**Price:** \$11,000.00

**Description:** Custom crafted from recycled Douglas fir

1. (2) raised beds 4' x 8' x 12" Plants Included 4k
2. (2) peaks 1k
3. (8) doors & walls 3k
4. (2) irrigation systems over head mimicking rain 2k

**Menu #B3**

**Maintenance:** \$400/monthly & seasonal check list

**Water:** Deep soak three times per week, Irrigation recommended

**Prefab:** Yes

**Work hours:** 1 month

**Options:** Food forest on perimeter, paths leading in and out.

**Note:** Cabins are animal protected top, sides, bottom, (16) doors, pitched roof – (growing room & aesthetics) sealed (non-toxic), fully planted, irrigated with timer, mulched, & delivered.



# Salad A Day Garden Box



**Name:** Salad A Day garden Box

**Price:** \$1,700.00 + or –

**Description:** 21 vegetable and herbs, box 4' x 8' x 12", soil fertilizer, delivery

**Menu #B4**

**Quantity:**

**Maintenance:** Weekly and seasonal check list

**Water:** Misting for greens. Deep soak three times per week, Irrigation recommended

**Prefab:** Yes

**Work hours:** 60hrs 3days

**Options:** Animal protection, irrigation, extra plants, biodynamic compost, sealer, pond liner protection, trellis, pea gravel, food forest, Teeple wall

**Note:** \$1,700.00 is an average price derived from "The Salad A Day Garden Box" here on our website and our installations. Scroll to the bottom of the page of the link below for extras and more details. Select your vegetables there. Base price is \$995.00.

**Link:** <http://edbl.net/internetspecial.html>

# Salad A Day Garden “Porch” Box



**Name:** Salad A Day Garden “Porch” Box

**Price:** \$2,200.00 + or -

**Description:** 21 vegetable and herbs, soil fertilizer, drainage system, delivery

**Menu #:** B5

**Quantity:**

**Maintenance:** Weekly and seasonal check list

**Water:** Misting for greens (seasonal). Deep soak three times per week,

**Irrigation** recommended

**Prefab:** Yes

**Work hours:** 75hrs. 4days

**Options:** Extra plants, biodynamic compost, sealer, pond liner protection, trellis

**Note:** \$800.00 is the cost for drainage on this custom porch design.

\$2,200.00 is an average price derived from installation experience. Scroll to the bottom of the page of the link below for extras and more details.

Select your vegetables there. Base price is \$995.00 from Salad A Day Garden Box

**Link:** <http://edbl.net/internetspecial.html>



# Garden Vegetable Box Formal



**Name:** Garden Box Formal

**Price:** \$2,500.00 per formal box (tan color in pic)

**Description:** Formal fine carpentry redwood capped beds 2' x 10' x 42".  
21 vegetable and herbs, soil fertilizer, drainage systems, delivery,  
irrigation

**Menu #B6**

**Quantity:**

**Maintenance:** Weekly and seasonal check list

**Water:** Misting for greens (seasonal). Deep soak three times per week,

**Irrigation recommended**

**Prefab:** Yes

**Work hours:** 80hrs. 5day

**Options:** Formal animal protection white washed cabinets, extra plants,  
biodynamic compost, sealer, pond liner protection, path way design and  
installation

**Note:** Base price \$2,500.00 per formal box includes plants, & soil. Select  
extras from "Salad A Day Garden Box".

**Link:** <http://edbl.net/internetspecial.html>



# All In One Raised Bed Vegetable Garden Food Forest #I



**Name:** All In One Vegetable Garden #I

**Price:** \$23,950.00

**Description:** Permaculture design, 4.5 Salad a Day Garden Boxes fully planted, Food forest (see Food Forest on the menu), vines, shade plants, native plants, (1) Teeple Living wall grid, living wall trellises, hardscape, Menu # B7

**Quantity:**

**Maintenance:** Weekly and seasonal check list

**Water:** Misting for greens (seasonal). Deep soak three times per week, Irrigation recommended

**Prefab:** Yes partially

**Work hours:** (4) laborers 4 weeks 500hrs.

**Options:**

**Note:**

**Link:**



# All In One Raised Bed Vegetable Garden Food Forest #II



**Name:** All In One Vegetable Garden #II

**Price:** \$19,272.00

**Description:** Two Salad a Day Garden Boxes fully planted, redwood fence with animal protection, stepping stones, (3) wine barrel planters, native drought tolerant plants, (5) fruit trees, (5) berry bushes (2) trellises, irrigation with misters, shade cloth

**Menu #:** B8

**Maintenance:** Weekly and seasonal check list

**Water:** Misting for greens (seasonal). Deep soak three times per week, Irrigation recommended

**Prefab:** Yes partially

**Work hours:** (5) laborers 3 weeks 500hrs.

**Options:** Formal animal protection white washed cabinets, extra plants, biodynamic compost, sealer, pond liner protection, path way design and installation

**Link:** <http://edbl.net/internetspecial.html>

# The Rustic One (vegetable garden)



**Name:** The Rustic One

**Price:** \$780.00 per bed (12) Rustic Beds = \$9,360.00

***Fence & hardscape not included.***

**Description:** Rustic rounded & mounded raised beds. Each bed includes organic soil, 20 plants (or seeded for maximized growing pace), 35lbs of biodynamic compost, wood trim 4" in height.

**Menu #:** B9

**Quantity:**

**Maintenance:** Weekly and seasonal check list

**Water:** Misting for greens (seasonal). Deep soak three times per week,  
**Irrigation recommended**

**Prefab:** Yes partially

**Work hours:** (5) crew members 6 days (240hrs)

**Options:** Fence style materials, # of beds

**Note:** Fence not included, Hardscape between beds not included in pricing.



# Formal Cucumber Cabinet

(animal protection)



**Name:** Formal Animal Protection Cucumber Cabinet

**Price:** \$1,890.00

**Description:** Custom cabinets above raised beds protecting from animal critters. Crafted custom carpentry. Sealed with non toxic Aqua Protect, white washed soy based stain. Constructed with 2"x3", 2"x4" redwood, recycled douglas fir, or wood of choice. Green coated chicken wire, brass handles, and hardware.

**Menu #B10**

**Quantity:**



**Maintenance:** Re sealed yearly, white washed

**Water:**

**Prefab:** Yes

**Work hours:** 60hrs.

**Options:** Stain is available in all different colors

**Note:**

**Link:**

# Living Wall Raised Beds



**Name:** Living Wall Raised Beds

**Price:** Un priced, hourly depending on materials chosen and sizes

**Description:** This can take on and linear shaped wall. Inside or outside. Great for a labyrinth. Made from wood, wire, high grade thick weed barrier cloth.

**Menu #** B11

**Quantity:**

**Maintenance:** Re sealed yearly

**Water:**

**Prefab:** Partial possibility

**Work hours:**

**Options:**

**Note:**

**Link:**

# Keyhole Garden

(permaculture)



**Name:** Keyhole Garden

**Price:** Un priced, hourly depending on materials chosen and sizes

**Description:** Choose an organic look and feel with the keyhole designed garden for easy access.

**Menu #B12**

**Quantity:**

**Maintenance:** Re sealed yearly

**Water:**

**Prefab:** Partial possibility

**Work hours:**

**Options:**

**Note:**

**Link:**



# Mosaic Gardens



**Name:** Mosaic Gardens Raised Beds

**Price:** Un priced, hourly depending on materials chosen and sizes

**Description:** Raised beds with mosaic capping. This is meticulous art work usually performed on hourly rates.

**Menu #B13**

**Quantity:**

**Maintenance:** Seasonal & bi yearly

**Water:** 3x's week

**Prefab:** Partial possibility

# Teeple Living Walls



# Roofs & Dwellings



# Teeple Cubby Room



**Name:** Teeple Cubby Room

**Price:** \$35,000.00

**Description:** Enjoy (30) to (60) 17" trays of greens. Two sided. Interior – Wooden slanted ceilings, (1) Sliding door entrance.

**Menu #:** C1

**Quantity:**

**Maintenance:** Two three times per year plant tray replacement

**Water:** Daily misting, 3 times per week deep soak, irrigation suggested

**Prefab:** Yes partially

**Work hours:** 350hrs. 5.5 weeks, Crew 3

**Options:** Sky lights, extra sliding door, perennial plants. See link below.

**Note:** Sky lights cover ½ of roof leaving room for (30) trays

**Link:** <http://edbl.net/teeple.htm>





# Teeple Waterfall Cabin



**Name:** Teeple Waterfall Cabin

**Price:** \$170,000.00

**Description:** Roof - Enjoy (30) to (60) 17" trays of greens. Two sided.

**Interior –** Wooden slanted ceilings, (1) Sliding door entrance. Bottom 10 x 12 with mini kitchen, & cozy sitting area, heated floor connected to a cob oven, hot water tank above. Piped to heated floor and for hot water sink.

**Deck –** wooden deck skirt, with front porch.



**Waterfall pond creek pumped from creek to glass roof section cascading down, circulating. Powered by solar, hydro electric, or what ever.**

**Menu #:C2**

**Quantity:**

**Maintenance:** Two three times per year plant tray replacement unless planted with perennials

**Water:** Daily misting, 3 times per week deep soak, irrigation suggested, depending on climate

**Prefab:** Yes, partially

**Work hours:** 1,000hrs. 12 weeks, Crew 3

**Options:** Sky lights, extra sliding door, perennial plants. See drawing picture below. Larger deck, container planters etc...

**Note:** Sky lights cover ½ of roof leaving room for (30) trays

**Link:**



## Teeple Waterfall Cabin Design Large Deck

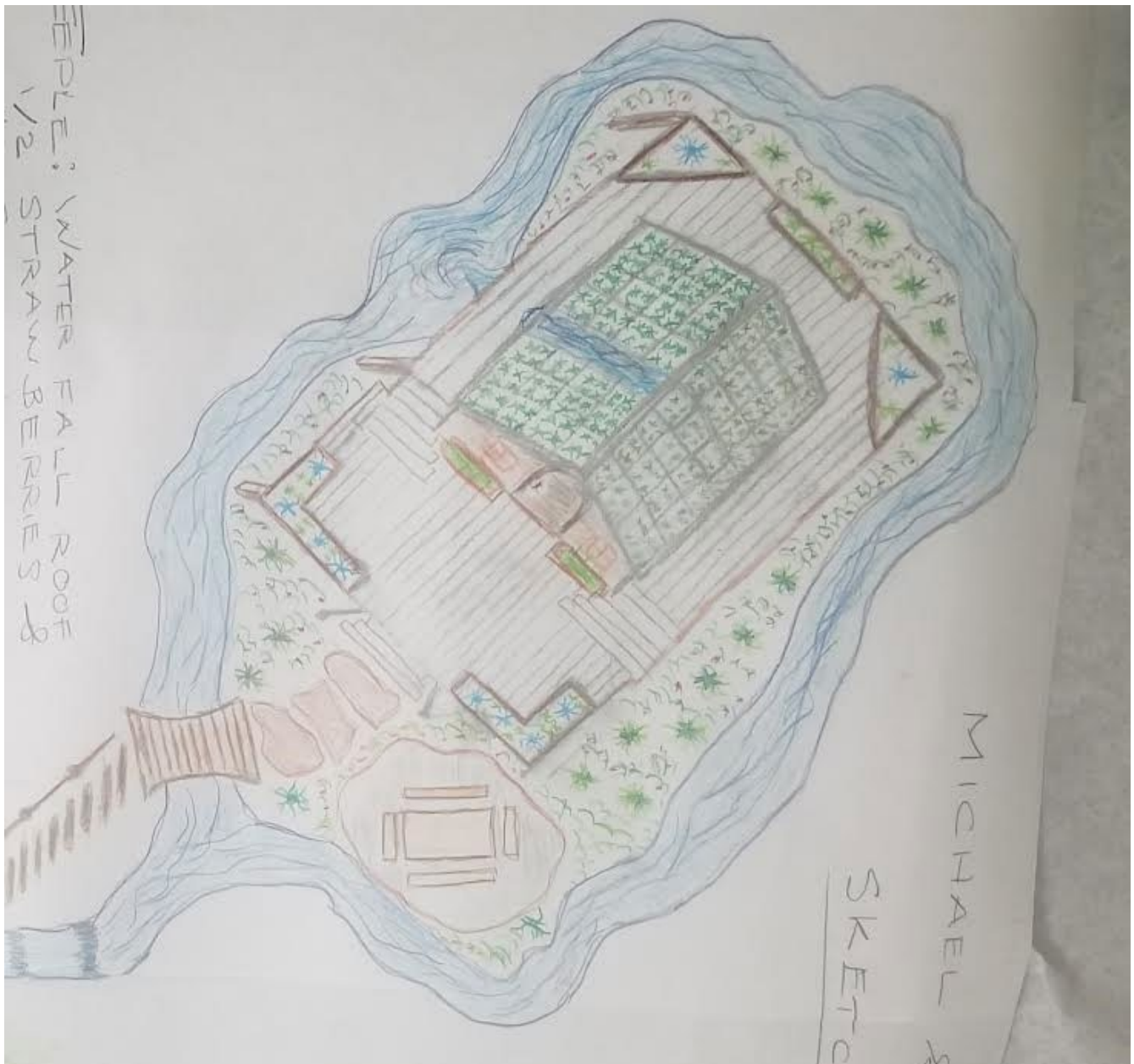

Teeple Waterfall Design Large, extended creek, edible landscape, & deck Zoomed out





# Teeple Apache

**Name:** Teeple Apache

**Price:** \$11,990.00

**Description:** Enjoy (50) 17" trays of greens. Two sided. 10' x 12' x 12'



**high.** Painted or stained. Stone leveled foundation.

**Interior –** Decomposed Granite (DG), Water proofed lined interior

**Wooden table**

**Menu #:** C3

**Quantity:**

**Maintenance:** Two three times per year plant tray replacement. Daily & weekly harvesting.

**Water:** Daily misting, 3 times per week deep soak, irrigation suggested

**Prefab:** Yes

**Work hours:** 200hrs. 3.0 weeks

**Options:** Drought tolerant plant trays, Cacti, non toxic paint or stain color, dry stacked wall, landscaped perimeter, food or native forest

**Note:** Plant selection per flat, can affect price drastically.

**Link:** similar to <http://edbl.net/teeple.htm>



# Teeple Apache Interior



# Mirror Cabin



**Name:** Mirror Cabin 15' x 15'

**Price:** \$140,000.00

**Quantity:**

**Maintenance:**

**Prefab:** No but possibility

**Description:** Metallic exterior with mirror effect. Trex deck included.

**Modern interior, includes kitchen, bath**

**Options:** Interior, heated floor, interior fire place, edible (landscape-choose from menu)

**Note:** Click on link below for list of Edible Flowers.

**Menu:** #C4













# Geodesic Dome Cob Home



**Name:** Geodesic Dome Cob Home

**Price:** \$1,500,000.00 + or -

**Description:** Enjoy a Cob Home fully landscaped, pond, creek, water falls, surrounding creek, interior creek. Sheltered within a dome.

**Outdoor landscapes, food forest, natives**

**Menu #:** C5

**Quantity:**

**Maintenance:** Typical home and garden maintenance

**Water:** From natural source

**Prefab:** Yes, partially, the dome

**Work hours:** 1yr

**Options:** Pond instead of cob house, or other options like music room, ice skating rink etc...

**Note:** Domes are wind resistant!



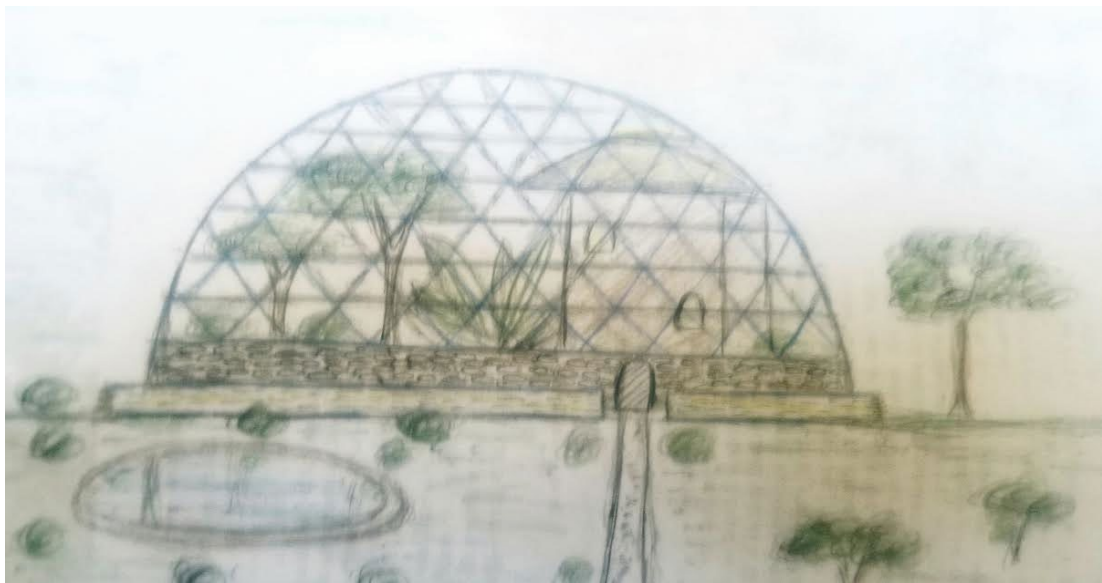

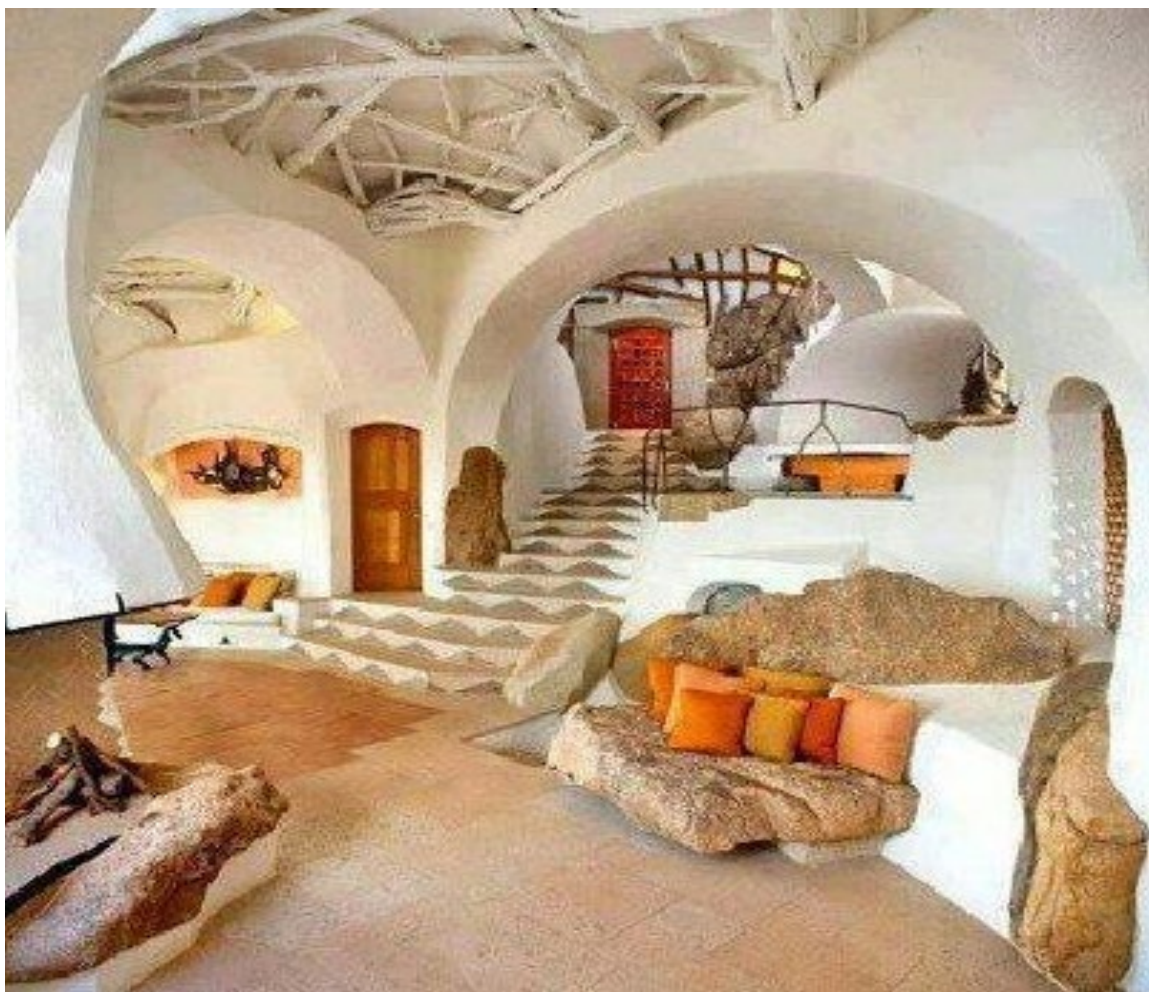



# Pyramid Home In Nature



**Name:** Pyramid Home In Nature

**Price:** Un- priced

**Description:** Pyramid home as in picture with all the bells & whistles of a home. Edible Landscape suggested. Live in the Frequencies of a pyramid.

**Menu #:** C6

**Quantity:** ...

**Maintenance:** ...

**Prefab:** No

**Work hours:**

**Options:** Different types of stones & capping

**Link:** ....



Another beautiful shape with water, pond or small lake



# Hobbit Home That Suits “Amy”



**Name:** Hobbit Home That Suits “Amy”

**Price:** \$160,000.00

**Description:** Custom crafted from recycled Douglas fir

1. Interior Verdura Block wall & cob walls
2. Living Roof
3. Hobbit Door
4. Facade – choose from wood, recycled bricks, cob clay
5. Interior windows with lighting
6. Mold proof with ventilation

**Menu #C7**

**Option:** Multiple hobbit homes connected with hallway tunnels, Food forest on perimeter

**Work hours:** 8 month five man crew

# Underground Dwelling

## “God's Architecture”



**Name:** Underground Dwelling

**Price:** \$5,000,000.00 + -

**Description:** Underground keeps the purity of the natural architecture. Any type of dwelling can be created below. Modern, rustic, and for what ever function one fancies. Wine cellar, food storage, or a full on home, living room, bathroom, & kitchen. This project can be built any different size.

**Menu #:** C8

**Quantity:**

**Maintenance:**

**Water:** From natural source

**Prefab:** Partially

**Work duration:** 1yr

**Options:**

**Note:**

**Link:**





# Maitreya Mt. Village Hobbit Home



**Name:** Maitreya Mountain Hobbit Home

**Price:** \$140,000.00 + or -

**Description:** Enjoy a Story book hobbit home fully landscaped, pond, creek, water falls. Outdoor landscapes, food forest, native plants

**Menu #:** C9

**Quantity:**

**Maintenance:** Typical home and garden maintenance

**Water:** From natural source

**Prefab:** No

**Work hours:** 1yr

**Options:** Pond instead of cob house, or other options like music studio, green house etc...









# Teeple Wall



**Name:** Teeple Wall

**Price:** \$5,580.00

**Description:** Enjoy (24) 17" trays of edible and or perennial living wall. Stained white wash or any color selection, or non toxic paint. Constructed with recycled douglas fir 2x4's and 2x6's.

**Menu #:** C10

**Quantity:**

**Maintenance:** Two three times per year plant tray replacement

**Water:** Daily misting, 3 times per week deep soak, irrigation suggested

**Prefab:** Yes

**Work hours:** 200hrs. 3.0 weeks

**Options:** Drought tolerant plant trays, Cacti, non toxic paint or stain



color, landscaped perimeter, food or native forest

**Note:** Plant selection per flat, can affect price drastically

**Link:** similar to <http://edbl.net/teeple.htm>



# Tortoise Teeple



**Name:** Tortoise Teeple

**Price:** \$3,500.00

**Description:** Enjoy (8) 17" trays of edible and or perennial living walls for your Tortoises!

**Menu #:** C11

**Maintenance:** Two three times per year plant tray replacement

**Water:** Daily misting, 3 times per week deep soak, irrigation suggested

**Prefab:** Yes

**Work hours:** 40hrs. 3 days

**Options:** Drought tolerant plant trays, Cacti, non toxic paint or stain color, landscaped perimeter, food or native forest

**Note:**

**Link:** similar to <http://edbl.net/teeple.htm>



# Living Roof Tool Shed



**Name:** Living Roof Tool Shed

**Price:** \$10,875.00

**Description:** Living Roof Tool Shed. 7' x 3' x7' with slightly pitched roof. Constructed from recycled douglas fir or redwood .

**Menu #:**C12

**Quantity:**

**Maintenance:** Sealed one time per year. Aqua Protect. Oiled non toxic

**Water:** Daily misting, 3 times per week deep soak, irrigation suggested

**Prefab:** Possible

**Work hours:** 120hrs. 12 days

**Note:** Plant drought tolerant sprouted vegetables or perennial

**Choose different shape Tool Shed hobbit look**





# Baby Teeple Tool Shed



**Name:** Baby Teeple Tool Shed

**Price:** \$8,500.00

**Description:** Living Roof, doors, sides, Tool Shed. 4' x 4' x 5' high.  
Constructed from recycled douglas fir or redwood .

**Menu #:** C13

**Quantity:**

**Maintenance:** Sealed one time per year. Aqua Protect. Oiled non toxic

**Water:** Daily misting, 3 times per week deep soak, irrigation suggested

**Prefab:** Possible

**Work hours:** 120hrs. 12 days

**Note:** Plant drought tolerant sprouted vegetables or perennial

# Vertical Living Wall Herb Cabinet



**Name:** Vertical Living Wall Cabinet

**Price:** \$2,875.00

**Description:** 2' x 4' x 5' Herb Cabinet with a bed at top and bottom. Filled with herbs, lettuces and perennial vegetables. Perfect next to the kitchen. Irrigation included \$500.00

**Menu #:** C14

**Quantity:**

**Maintenance:** Re compost with every planting, seasonal or bi-yearly replanting. Side wall is made of succulents replace as needed once per year.

**Water:** 3 times per week deep soak, irrigation suggested

**Prefab:** Yes partially

**Work hours:** 60hrs. 1 week, Crew 2

**Options:** Leave natural color or any color. Soy based paint.

**Note:** Must get 5hrs. Direct sun





# Archie Bunker



**Name:** Archie Bunker

**Price:** \$180,000.00 - \$250,000.00

**Description:** 15' x 20' x 8' x 10" thick walls, and ceiling

(1) Doorway entrance



- (2) walls 1 ceiling
- (3) Piping
- (4) Electric
- (5) Landscaped roof
- (6) Optional finished interior

**Menu #C15**

**Quantity:**

**Maintenance:**

**Prefab: No**

**Work hours: 6 week**

**Options: Finished interior, Archie Bunker VHS vids**

# Pavilion Tipi – Heated Floor



**Name:** Pavilion Tipi

**Price:** \$80,000.00 + -

**Description:** 15' dia x 14' height Tipi

**1** Doorway entrance

- (1) Tipi
- (2) Heated Floor, copper piped
- (3) Earthen Cob oven & hot water tank
- (4) Earthen Pavilion – clay sand 25' x 25' x 10"
- (5) Arbor
- (6) Steps & Path

**Menu #C16**

**Quantity:**

**Maintenance:**

**Prefab:** No

**Work hours:** 7 weeks

**Options:** Gardens, food forest, paths





Actual Picture TP Installed from our TP expert, Brian  
Location - Northern California



# Cob Bench Hang Out



**Name:** Cob Bench Hang Out

**Price:** \$22,000.00 + -

**Description:** 18' Diameter

**1** Doorway entrance

- (1) Circular Cob Bench
- (2) Earthen Cob Floor
- (3) Heated bench
- (4) Cob Oven Stove in Center or outside entrance see picture below

**Menu #C17**

**Quantity:**

**Maintenance:**

**Prefab:** No

**Work hours:** 7 weeks

**Options:** Gardens surrounding bench, living roof over bench, trellises





# Succulent Living Wall

**Name:** Succulent Living Wall 7' x 14' - \$200.00 per SF

**Price:** \$20,000.00

**Description:** Custom built & designed



1. (1) Support backing, heavy duty bolted
2. (1) Frame & shelving plant support
3. (30) Succulent flats
4. (1) irrigation systems

**Menu #C18**

**Maintenance:** \$100/monthly & seasonal check up

**Water:** Deep soak three times per week, Irrigation recommended

**Prefab:** Yes, partial

**Work hours:** 1 month crew 4



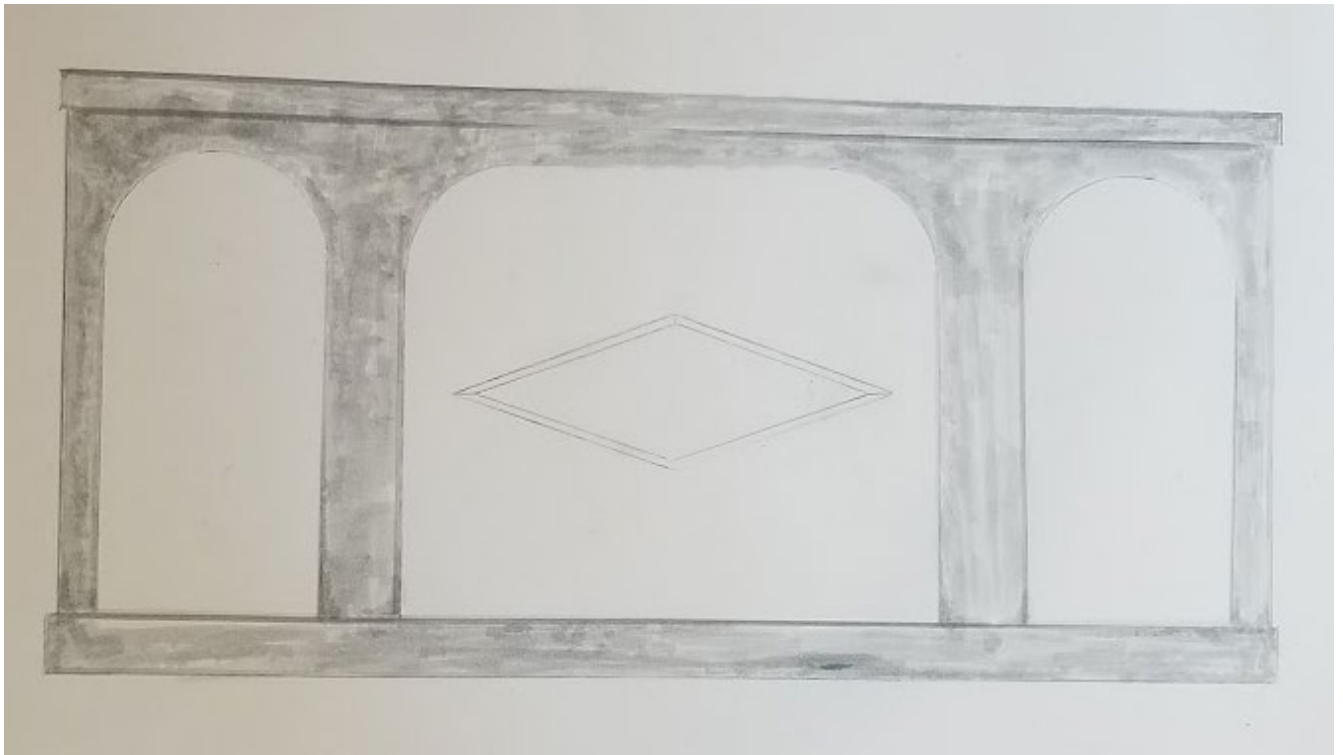

# Food Forests & Food





# Food Forest



**Name:** Food Forest

**Price:** \$4,375.00 20'x20'area. Average \$20.00 per square foot.

**Menu #:** D1

**Quantity:**

**Maintenance:** Seasonal mulching

**Water:** Deep soak three times per week. Irrigation included

**Prefab:** No

**Description:** (3) or (4) Perennial fruit trees , (5) or (6) bushes, (3) flats herbs, (2) flats perennial vegetables, (2) climbing edibles with (2) trellises, ground cover, (2.5yds) organic soil, (60lbs) biodynamic compost. This Food Forest has: Pomegranate, pineapple guava, passion fruit vine, citris, kale, strawberry, blueberry, dill, fennel. oregano, asparagus, rose hips, perennial spinach, and the list goes on...

**Options:** Have food forest surrounding a relaxing hang out, meditation area, another theme. Plants love water and the sound of it. Consider creek. waterfall, and or pond near or surrounding Food Forest.

Mimicking nature in our designs. See Native Forest (reforestation) here

on menu.

**Note:** Density of planting can effect food forest pricing. This one is densely planted. All installations require design, locating all plants. See design menu. Requires five hours of direct sun light in summer.

**Link:**



# 7,777 Tree Planting



**Name:** 7,777 Tree Planting

**Price:** \$30 per tree using Ellen White Method Planting

**Description:** Enjoy healing the earth, her rhythms, her cycles, her weather because everyone loves trees & their healing properties. Help restore nature's original patterns with tree planting. It rains in the rain forest for a reason.

**Menu #:** D2

**Quantity:**

**Maintenance:**

**Water:** Drip line estimated separately

**Prefab:** No

**Work hours:** .5hrs per tree

**Options:**

**Note:**

# Mini Food Forest

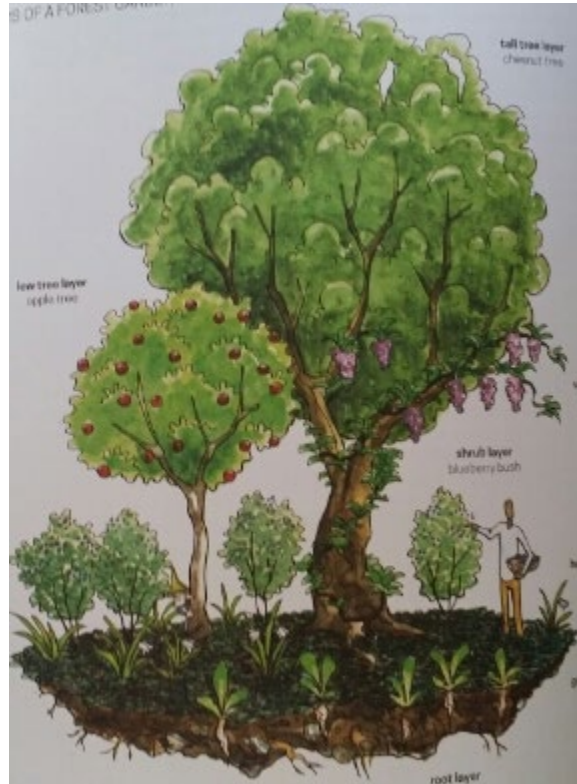

**Name:** Mini Food Forest

**Price:** \$2,500.00 10'x10'area. Average \$20.00 per square foot.

**Menu #:** D3

**Quantity:**

**Maintenance:** Seasonal mulching

**Water:** Deep soak three times per week. Irrigation included

**Prefab:** No

**Description:** (2) Perennial fruit trees, (4) bushes, (10) climbing edibles with trellis, ground cover crop nitrogen fixer from seed, organic soil, (30lbs) biodynamic compost. This Food Forest has: Pomete, passion fruit vine, citris, artechoke, strawberry, blueberry, leeks, and the list goes on...

**Options:** Have food forest surrounding a relaxing hang out, meditation area, another theme. Plants love water and the sound of it. Consider creek. waterfall, and or pond near or surrounding Food Forest.

Mimicking nature in our designs. See Native Forest (reforestation) here on menu.**Note:** Density of planting can effect food forest pricing. All installations require design, locating all plants. See design menu.

Requires five hours of direct sun light in summer.



# Fruit Trees



**Name:** Fruit Trees

**Price:** \$300.00 - \$1,150.00 5gal non fruiting to 24" boxed and fruiting

**Menu #:** D4

**Quantity:**

**Maintenance:** Mulching two times per year

**Water:** Deep watering two to three times per week

**Prefab:** No

**Description:** Choose from avocado, apple, fig, pomegranate, citrus, guava, sapote, apple, kumquat, olive, cherrimoya, pear. Trees are planted with biodynamic compost, topsoil ½ mixed with native soil. We take great care and time in our planting using professional techniques to ensure long lasting fruitful results. Delivery included. Location on property can alter pricing.

**Options:** Food Forest are highly recommended. Fruit trees and all plants love company. This strengthens the immune system of the all the plants

in the community. Trees planted alone have a hard time surviving in their younger years. They do much better with company, as they do in nature.

**Note:** We only guarantee plants, planted in plant guilds (families) from our designs with proper composting, fertilizer, irrigation, and companion planting.

**Link:**



# Bed of Basil “FROM SEED”



**Name:** Bed of Basil “FROM SEED”

**Price:** \$300.00

**Menu #:** D5

**Quantity:**

**Maintenance:** Harvest weekly, remove when going to seed (3-4moth life)

**Water:** Deep soaking three times per week

**Prefab:** No

**Description:** Planted from bulk basil seeds. Covers area 2'x10'

**Biodynamic** compost included.

**Options:** .Other seeds can be used to maximize space in smaller garden areas i.e. chard, baby greens, arugula

**Note:** Materials estimated for Bed of Basil is seeds, and biodynamic compost. The raised bed in the picture is not included.

**Link:** ....

# Edible Flower Garden



**Name:** Edible Flower Garden

**Price:** \$300.00

**Menu #:** D6

**Quantity:**

**Maintenance:** Seasonal mulching, turning plants back into the soil, and transplanting where needed.

**Water:** Deep soaking three times per week

**Prefab:** No

**Description:** Planted from bulk seeds. Covers area 2'x10'

**Options:** Plant from mature plants in a designed larger garden. 5Gal to 25gal. This estimate is planted from “seed”. \$15.00 per square foot.

**Link:** <http://lemonverbenalady.blogspot.com/p/a-list-of-edible-flowers.html>



# Passionate Passion Fruit Fence



**Name:** Passionate Passion Fruit Fence

**Price:** \$150.00 minimum order (3)

**Menu #:** D7

**Quantity:**

**Maintenance:**

**Water:** Deep soaking three times per week

**Prefab:** No

**Description:** Passion flower plants planted every 5' to 7' along fence or trellis



**Options:** Grapes, kiwi, honey suckle, jasmine

**Note:** Must have full sun 5hrs. per day

# Permaculture Hideout

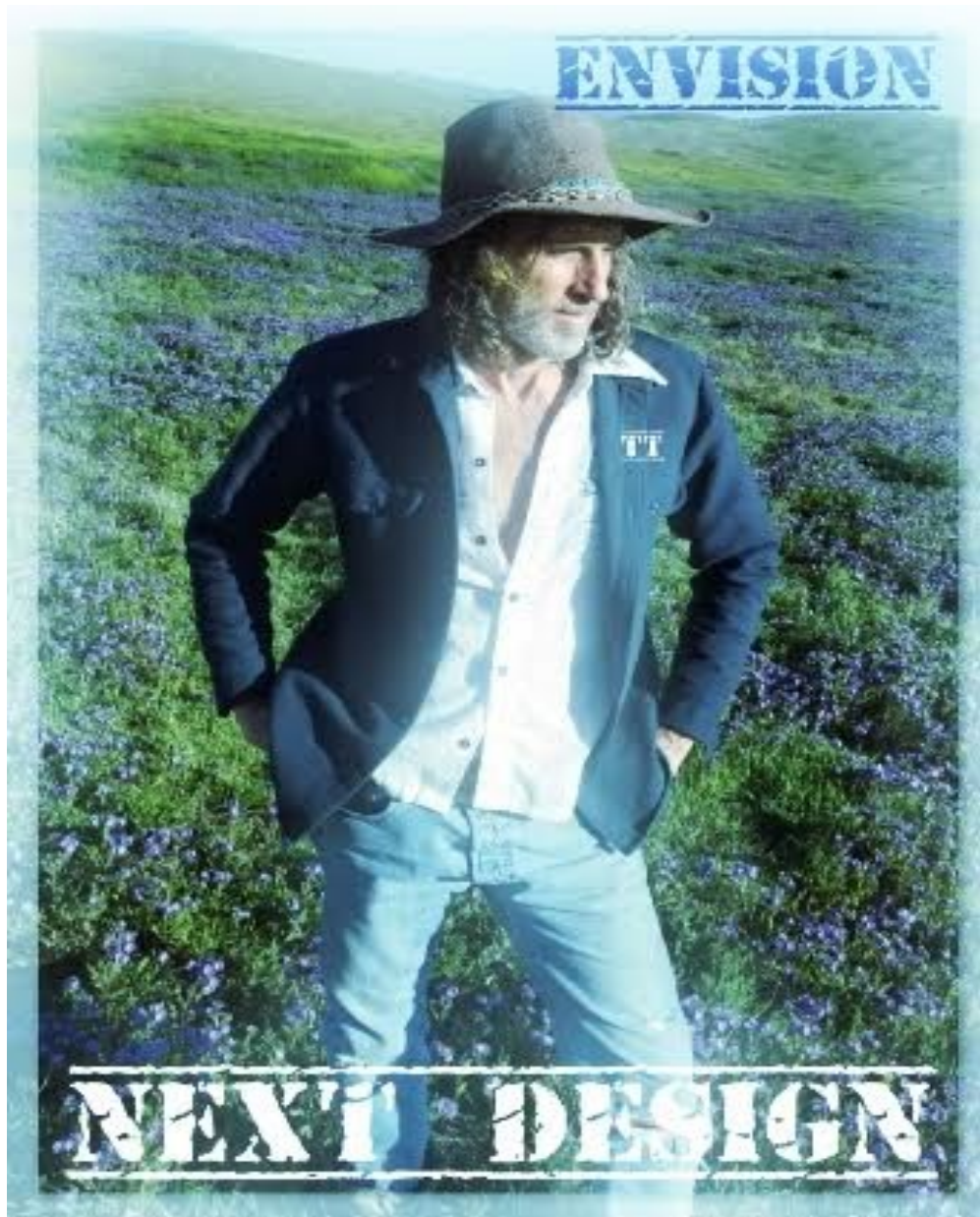



# Living Roof



**Name:** Living Roof Edible Garden Sanctuary

**Price:** \$48,000.00

**Description:** An all in one Living Roof comes complete with deck, edible raised garden boxes, drought tolerant plants, permeable porous living roof technology, soil, ground covers, and simple light hardscaping.

**Menu #:** E1

**Quantity:** ...

**Maintenance:** ...

**Water:** Three times per week drench

**Prefab:** Partial

**Work hours:** Two months. Crew of 5 to 10

**Options:**

**Note:** All installations are to be planned, designed to scale, plan view and elevation, engineered for weight. for most accurate estimate.

**Link:** ....

# The Village Look

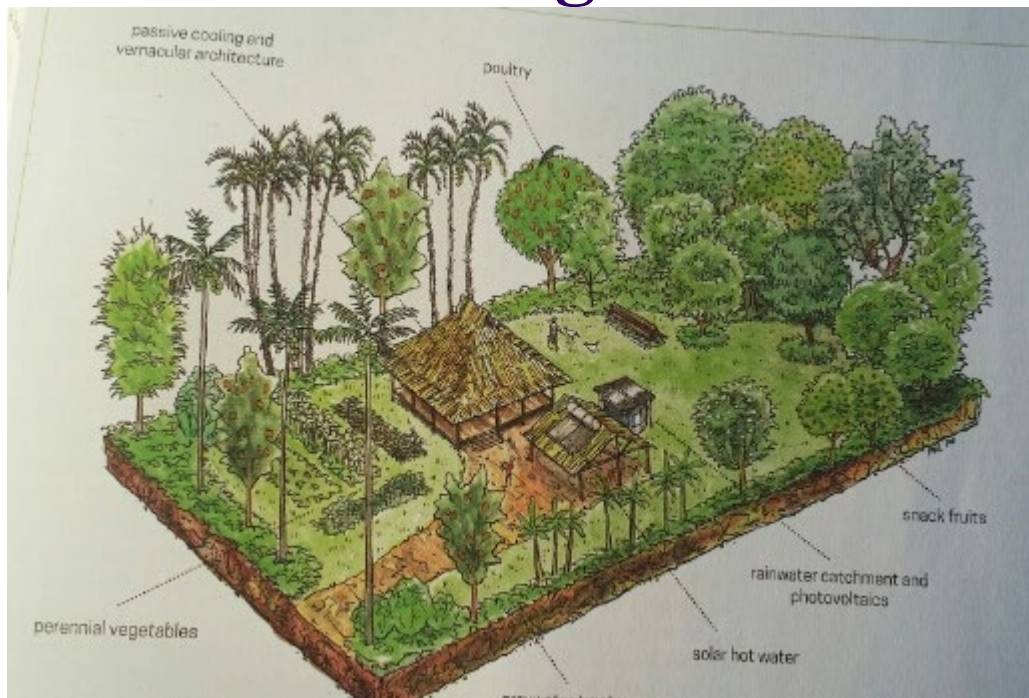

**Name:** The Village Look

**Price:** \$85,000.00

**Description:** An all in one Food Forest, natives, fruit trees, edible shrubs, bushes, central open end hut, with smaller hut. 3 raised Salad A Day Box vegetable gardens 10' x 4' x 16". The right side of garden has a canape, planted closer with canape trees

**Menu #:** E2

**Quantity:** ...

**Maintenance:** ...

**Water:** Three times per week drench

**Prefab:** No

**Work hours:** Two months. Crew of 5 to 10

**Options:** This estimate on the landscape is for mature trees 24", 15gal shrubs, and bushes. Greatly reduce price by planting 15gal fruit trees and 5gal shrubs.

**Note:** All installations are to be planned designed to scale, plan view and elevation, for most accurate estimate.

**Link:** ....



# Formal Food Forest



**Name:** Formal Food Forest

**Price:** \$32,000.00

**Description:** Using this design uncovering a more formal look. 30 - 40 Native and or fruit trees surround the perimeter. Mounded raised vegetable beds, perennial vegetables, herbs, berry bushes, native plants, ground cover, scented plants, color, keyhole access paths. 180 plants, shrubs, herbs, fruit trees, mid, dwarf, and full size. Labor, clear cutting area, re-establishing soil, amending soil, adding, biodynamic compost, and cover cover crops. Dimensions 50' x 120'. Irrigated.

**Menu #:** E3

**Quantity:** ...

**Maintenance:** ...

**Water:** Three times per week drench

**Prefab:** Work hours: 5 weeks. Crew of 3 to 5

**Options:** ½ size formal forest is ½ the price. ½ of this size is ½ that price and so on.

**Note:** All installations are to be planned, designed to scale, plan view and elevation, for most accurate estimate.

# Fairy Tunnel Trellis



**Name:** Fairy Tunnel Trellis

**Price:** \$11,500.00

**Description:** Pre Fab Sauna

1. \$5,000.00 Recycled Tree
2. \$6,500.00 custom construction

**Menu #E4**

**Maintenance:**

**Prefab:** No



# Circular Sauna



**Name:** Circular Sauna

**Price:** \$12,000.00

**Description:** Pre Fab Sauna

1. Comes with heater
2. Delivery & installation included

**Menu #E5**

**Maintenance:**

**Prefab:** Yes





# Lady's & Gentlemen “The Doors”



**Circular Sliding**



**Winter Window**



**Zabiba Arched**





## Magazine Stone Door

**Name:** The Doors

**Price:** \$3,500.00 - \$7,500.00

**Description:** Choose from a variety of custom made doors made from recycled wood & other materials, like slate, stone & metals.

**Menu #:** E6

**Quantity:** ...

**Maintenance:** Sealants

**Water:**

**Prefab:** possibly

**Work hours:** Varies



**Winter Door**



# Permaculture Natural Playgrounds



**Name:** Permaculture Natural Playgrounds

**Price:** Time & materials

**Description:** Custom crafted from as natural as can be materials

**Menu #:** E7

**Quantity:** ...

**Maintenance:** Sealed yearly

**Water:**

**Prefab:** No



# Swing



**Name:** Custom Swing

**Price:** \$650.00

**Description:** Custom wooden swing and rope.

**Menu #:** E8

**Quantity:** ...

**Maintenance:** Sealed yearly

**Water:**

**Prefab:** No

**Work hours:** 1 day. Crew of 2

**Options:** Chain link, with spinning swivel. Custom thicker seat cut from

scavenged eucalyptus, and or available. Ad \$350.00.

**Note:**





# Dan's Solarium Mother Green House (HUGE)



**Name:** Green House

**Price:** \$3,000,000.00 + or -

**Description:** 200 LF x 15 LF x 10' (Ceiling) Green House. Wood framed. Three door, windows, circular window, waterfall creek, irrigated, sky light windows releasing excess heat. Multiple Raised Bed Food Forests,

trellises, irrigation, misters, drip and decorative stone paths. Electric, .  
\$2,000,000.00 Green House labor, back wall, water features, irrigation  
etc...

\$400,000.00 Materials, cinder block, window, wood, hardware, local  
timber harvest

\$70,000.00 Food forests, plants, trees, irrigation,

\$25,000.00 Solar – solar panels and install

\$40,000 Decorative stone floor path & border

\$40,000.00 grow lights

**Menu #: E9**

**Quantity:**

**Maintenance:** Sealant once per year

**Prefab:** Partial

**Work hours:** 1yr . Crew of 5 200+ work days









# Green House



**Name:** Green House

**Price:** \$18,650.00

**Description:** 8' x 16' x12' Green House. Wood framed. One door, rear windows, automatic sky light windows releasing excess heat. Four raised Salad A Day Garden Boxes, irrigation, misters, drip and decorative stone paths. Electric, irrigation.

\$4,500.00 Green House and shipping

\$4,000.00 Labor, erecting sealing, animal proofing

\$1,200.00 Irrigation to all beds, emitters, drip, misters, & timer

\$1,500.00 Electric

\$6,000.00 (4) Raised Salad A Day Garden Boxes

\$1,200.00 Decorative stone floor

\$250.00 (1) grow light

**Menu #:** E10

**Quantity:**

**Maintenance:** Sealant once per year

**Prefab: Partial**

**Work hours: 7 days. Crew of 5**



**Note:** All installations are to be planned, designed to scale, plan view and elevation, engineered for weight. for most accurate estimate.

**Link:** <http://www.greenhousemegastore.com/product/sunshine-gardenhouse-8-foot-wide/hobby-greenhouse-kits-by-covering>



# Out House Composting Toilet



**Name:** Out House Composting Toilet

**Price:** Un priced

**Description:** 12' x12' Out House. Wood framed. One door, rear side windows

**\$1,200.00** Decorative stone floor



**Menu #: E11**

**Quantity:**

**Maintenance:**

**Prefab: Partial**

**Work hours: 8 weeks, 4 man crew**

**Maintenance:**

**Water:**

**Prefab: No**

**Work hours: 6 weeks. Crew of 2 & 3**

**Options: Choose any style dwelling, hobbit, Teeple, rustic, modern**

**Note:**



# Drought Tolerant Island



**Name:** Drought Tolerant Island

**Price:** \$6,610.00

**Description:** 15' x 15' drought tolerant decorative stone plant installation. Roughly \$25.00 S.F.

\$1,700.00 White decorative stone pea gravel with delivery

\$2,200.00 Planting labor

\$ 600.00 Removal lawn turf

\$ 650.00 Irrigation tying into existing, install & testing

\$ 460.00 Plants, cacti, succulents, trees, shrubs

**Menu #:** E12

**Quantity:**

**Maintenance:**

**Water:** a2x's/week

**Prefab:** No

**Work hours:** 4 days. Crew of 2 & 3

**Options:**

**Note:** Large white stones in picture not included. Decorative white stone is much more expensive than mulch, decomposed granite (DG) to fit budget



# Gray Water Outdoor Kitchen

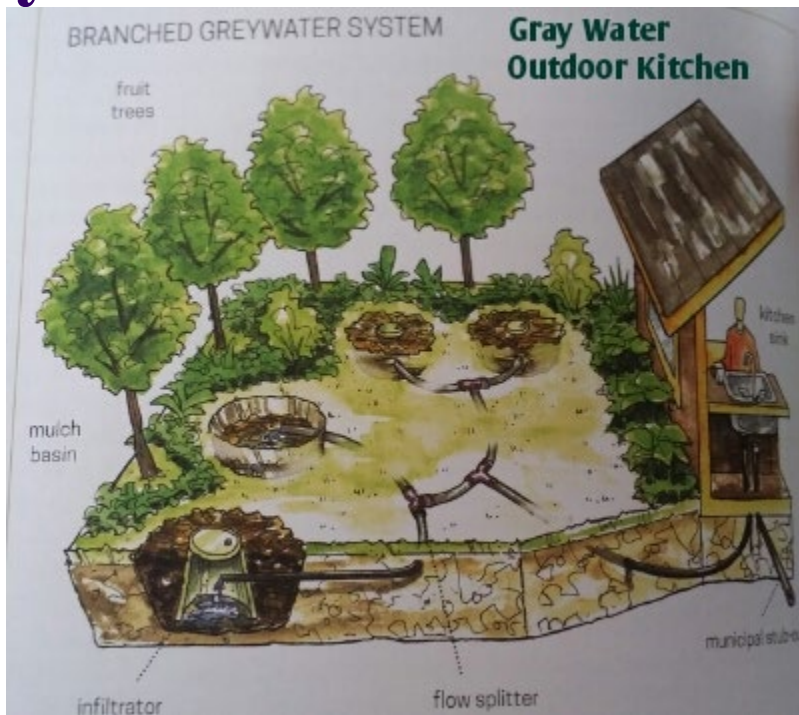

**Price:** Custom – Time & materials

**Description:** Kitchen drainage to trees, shrubs, and basins

**Menu #:** E13

**Quantity:**

**Maintenance:**

**Water:**

**Prefab:** No

**Work hours:** 4 days. Crew of 2 & 3 pending on size of project \$3,000.00  
+ materials "estimate"

# Drought Tolerant Succulent Buddha Garden



**Name:** Drought Tolerant Succulent Buddha Garden

**Price:** 3,800.00

**Description:** 2' x 7' area loaded with drought tolerant beautiful colorful succulents, Buddha statue, St, Francis, 4 containers, (1) trellis

**Menu #:** E14

**Quantity:**

**Maintenance:**

**Water:**

**Prefab:** No

**Work hours:** 1.5 days. Crew of 2 pending on size of project and materials selected \$3,000.00 + materials "estimate"

**Options:**

**Note:**

**Link:** ....



# Native Plant Restoration



**Name:** Native Plant Restoration (20) native trees 3' - 5' height

**Price:** Hourly or estimate roughly \$5,000.00 labor plus materials  
\$9,500.00 Trees, shrubs, seeds, ground cover

**Menu #:** E15

**Description:** (20) 5gal native trees, (60) shrubs, (70) flats ground cover, native grasses from seed: 20hrs prep, 100 hrs tree, shrub, ground cover installation, 3man crew, irrigation to each tree and tying into existing irrigation

Clearing designated area of all non natives, trees, shrubs, ground cover and grasses, for example eucalyptus, pines, peppers. This alone can be an extremely meticulous project using no chemicals. We then plant from a choice of pure native only, non hybridized trees, shrubs, ground covers, seed and grasses. We have local professionals knowledgeable to the local region for this specialized work.

Hourly and or \$100,000.00 + or = per square acre

Choose from many others not listed:

Holly Leaf Cherry (Tree)  
Elderberry (tree)  
Coast Live Oak (tree)  
Black Walnut (tree) below pic  
Red Shank (Tree) plant far from house – flammable  
Chalk Dudlelya (succulent)  
Humbaly Lili (flower)  
Pherelia (flower)  
Coast Goldfields (flower) in pic above  
Lupine (bush purple flower)  
Coriopsis (bush)  
Sages – white, black, purple (bush)  
Toyan (bush)  
Ceanothos (bush)  
Manzanita, little apple (bush)  
Wild Zumack (bush)  
Siugar Bush

**Water:** Weekly

**Work hours:** 5.0 – 6.0 days. Crew of 3 pending on size of project and materials selected \$10,000.00 + materials “estimate”







# Living Garden Table



**Name:** Living Garden Table

**Price:** \$23,000.00 - \$33,000.00

**Description:** Combining nature, art, and technology into one piece that complete the formal edible garden. Relying on skilled technicians, custom craftsman, and precision technology, we bring you quality crafted architecture. Legs are from solid eucalyptus, or other local wood drilled for irrigation, and protected with a life time guaranteed sealant penetrator. The table is constructed with slate, and or copper, iron with custom trays for vegetables, and herbs growing from right off the top. There is a mini trough creek running strait through the center, creating a waterfall affect, circulating back up through table legs, completing a unique table that make outdoor dining something to really talk about. This project needs to be designed for each custom installation including irrigation locations and source, exact size width, height, length, number of plant trays, water drainage from plants, specific materials preferred, colors, scents of plants, material colors (weathering affects), floor materials and maintenance. One can literally cut their salad and herbs



**right there growing from the Living Garden Table. Seats sixteen people.**

**Menu #: E16**

**Quantity: ...**

**Maintenance: ...**

**Water: Three times per week drench**

**Prefab: Possibly**

**Work hours: One month. Crew of 4**

**Options:**

**Note: All installations are to be planned, designed to scale, plan view and elevation, engineered for weight. for most accurate estimate.**

**Link: ....**

# Verdura Block Living Wall



**Name:** Living Wall - Verdura Block

**Price:** \$80 Per S.F. Face Wall

**Description:** Includes crushed stone foundation, Verdura Block (cement), and labor.

**Menu #:** E17

**Quantity:** ...

**Maintenance:** ...

**Water:** 1x's / times per week drench, irrigated

**Prefab:** No

**Work hours:** Time & materials

**Options:** Different types of stones & capping

**Link:** ....



# Dani's Artistic Carved Out River Rock Wall



**Name:** Dani's Artistic River Rock Wall

**Price:** \$70 Per S.F. Face Wall \$20.000.00 (this wall)

**Description:** Includes crushed stone foundation, River rock face, and labor.

**Menu #:** E18

**Quantity:** ...

**Maintenance:** ...

**Water:**

**Prefab:** No

**Work hours:** Time & materials 2 week approx. 2 - 3 man crew

**Options:** Plants are planted between Vedura Block creating a living wall.

**Note:** Some walls are more or less involved then others. Blocks come in different sizes and colors. Irrigation & plants are not included with this estimate.

**Link to video:** (24) Dani's River Rock Wall - YouTube





# Garden Room Malibu Retreat



**Name:** Garden Room Malibu Retreat

**Price:** \$12,500 Per S.F. Face Wall

**Description:** Includes reclaimed eucalyptus wood, bench, two entrances. We call this “un-carpentry” because when using curved wood, every cut is angled. This adds challenge and time to the work, This room here required the removal of a eucalyptus tree, transport, and 5 weeks of construction involving a crew of six, full and part time. It's held together with heavy duty screws, 3” to 6” long, bolts on the corners. The wood is permanently sealed with Aqua Protect (a penetrator) that petrifies the wood. It had life time guaranty. Pieces are sealed prior to construction so every crevice is sealed. Definitely art in the making. No two garden rooms are the same. Built to last.

**Menu #:** E19

**Quantity:** ...

**Maintenance:** Sealed oiled 2x's yearly

**Water:**

**Prefab:** No

**Work hours:** 120hrs. Per week crew of 3 to 6.

**Options:**

**Note:** Price can vary depending on reclaimed wood and tree surgery removal involved to make the project possible.

**Link:** [...](#)



# Topanga Tommy Teeple Steps



**Name:** Topanga Tommy Teeple (14) Steps

**Price:** \$8,700.00

**Description:** Includes reclaimed oak slabs, and oak railings. We call this “uncarpentry” because when using curved wood, every cut is angled. This adds challenge and time to the work, . It's held together with heavy duty screws, 3” to 6” and bolts where required. The wood is permanently sealed with Aqua Protect (a penetrator) that petrifies the wood. It has a life time warranty. Pieces are sealed prior to construction so every crevice is sealed.

Definitely art in the making. A show piece. Custom art.

**Menu #:** E20

**Quantity:** ...

**Maintenance:** Sealant applied 2x's per year.

**Water:**

**Prefab:** No

**Work hours:** 120hrs per week crew of 3 to 6. 3 to 4 weeks.

**Options:**

**Note:** Price can vary depending on reclaimed wood, deliveries and tree surgery removal involved to make the project possible.

**Link:** ...



# Creek – Your Own



**Name:** Creek – Your Own

**Price:** \$40,000 - \$70,000

**Description:** Includes bog plants, wet land plants, liner, rocks, in an exquisite landscape. Price varies from creek to creek, size, depth, and landscape selection.

**Menu #:** E21

**Quantity:** ...

**Maintenance:**

**Water:**

**Prefab:** No

**Work hours:** 2-3weeks. Per week crew of 4 to 6.

**Options:**

**Note:** Price varies from creek to creek, size, depth, and landscape selection. All installations are to be planned, designed to scale, plan view elevation, and illustration, engineered for weight. for most accurate estimate

# Natural Swimming Pool



**Name:** Natural Swimming Pool

**Price:** \$100,000 + -

**Description:** Includes bog plants, wet land plants, liner, rocks, in an exquisite landscape. Price varies from poop to pool, size, depth, and landscape selection.

**Menu #:** E22

**Quantity:** ...

**Maintenance:**

**Water:**

**Prefab:** No

**Work hours:** 2-3weeks. Per week crew of 4 to 6.

**Options:**

**Note:** Price varies from creek to creek, size, depth, and landscape

## Sliding Living Roof Composter





**Name:** Sliding Living Roof Composter

**Price:** \$9,700.00

**Description:** Built from Reliaboard recycled lumber with a 29yr+ life. 3' x 7' x 3' deep.

**Menu #:** E23

**Quantity:** ...

**Maintenance:**

**Water:**

**Prefab:** No

**Work hours:** 2weeks. Per week crew of 3 to 4. 200hrs

**Options:**

**Note:**

**Link:** <https://www.youtube.com/watch?v=YnROv32L-iI>



# Simple Composter



**Name:** Simple Composter

**Price:** \$3,600.00

**Description:** Built from recycled douglas fir. 7' x 7' x 2.5' deep.

**Menu #:** E24

**Quantity:** ...

**Maintenance:**

**Water:**

**Prefab:** No

**Work hours:** 3days crew of 3 to 4. 60hrs

**Options:**

**Note:**

**Link:** ....

## Permaculture Ice Skating Pond

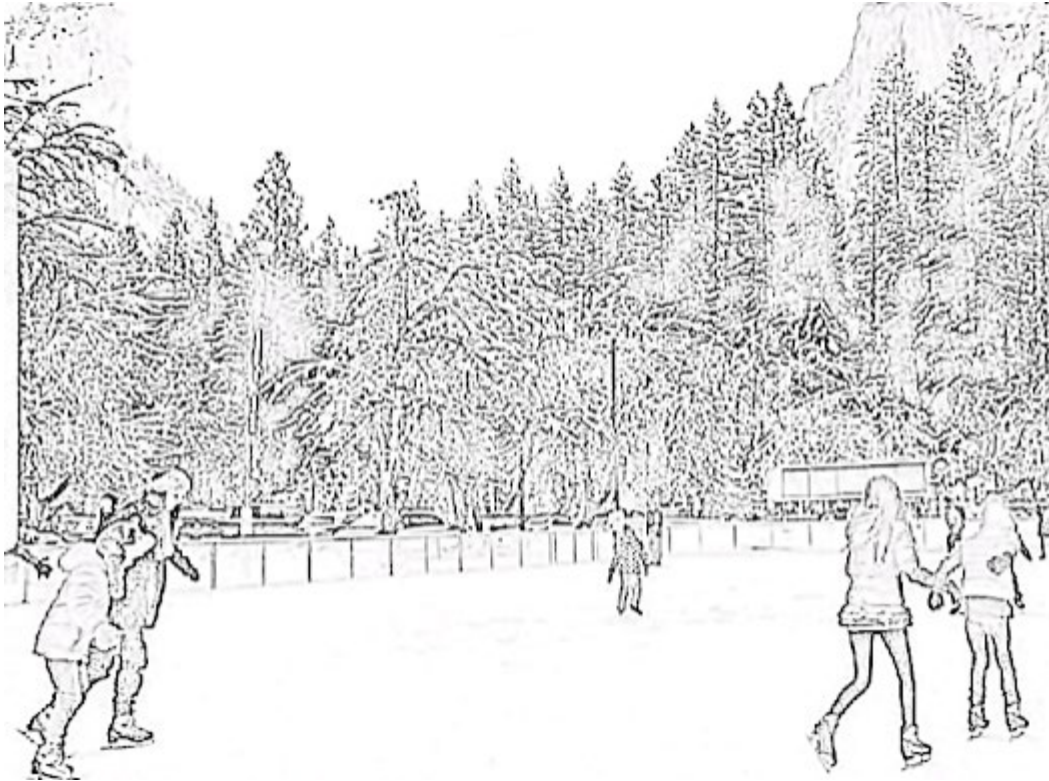

## Old School Rink Of The North

“Earthen Island To Warm Up”

**Name:** Permaculture Ice Skating Pond Rink

**Price:** Un-priced

**Description:** Rink boards built from recycled douglas fir., pond liner, depth- 1'-2', (2) gates, centered earthen island with cob stove, surrounded by pine forest and or native tree landscape.

Roof similar to circus tent or high pitched shade cloth to handle snow.

**Menu #:** E25

**Quantity:** ...

**Maintenance:** Wood Sealed once per year

**Water:**

**Prefab:** No

**Work months:** 3 to 6

**Options:** Island with heated earthen cob bench center of pond

**Note:** Best if rinks are fed by actual creeks





# Figure Skating Rink Of Curves Connected To:



Old School  
Rink Of The North  
“Earthen Islands To Warm Up”

**Name:** Permaculture Way Curvy Figure Skating Pond Rink

**Price:** Un-priced

**Description:** Rink boards built from recycled dauglas fir., pond liner, depth- 1'-2', (2) gates, earthen islands with cob stoves, surrounded by pine forest and or native tree landscape. Rink shaped with curvature, lots of landscaping and connected with an ice surface, and fairy tunnel trellis connected to the Rink of The North. Roof similar to circus tent or high pitched shade cloth to handle snow.

**Menu #:** E26

**Maintenance:** Wood Sealed once per year

**Prefab:** No

**Work months:** 3 to 6

# Barrels & Containers Of Fun

## Tomato Barrels



**Name:** Tomato Barrel

**Price:** \$895.00

**Menu #:** F1

**Quantity:**

**Maintenance:** Deep soak 1 time per week

**Water:** Deep soak three times per week. Irrigation recommended

**Prefab:** Yes

**Description:** includes Tomatoes in a barrel

Oak wine barrel , Bio dynamic compost (1) bag

Tomato fertilizer organic Dr. earth, penetrator application and labor (pre sealer life time) sealer application non toxic oil, Removal of tops wooden wine barrel, drill holes, 3" crushed stone (drainage), felt liner (drainage), (4) 1" fire bricks gray, black or rust color, Pond liner, lining inside of three barrels, (1) Tomato cages, (4) bags organic soil delivery and installation, soil/plants/cages, (1) organic heirloom



tomato plant

**Options:** ½ Barrel ½ price. Minimum order – two. Plant greens and or any vegetables as a raised bed.

**Note:** as Click on the Salad A Day Garden Box link, scroll down to the bottom for extras, applicable also to the barrel.

**Link:** <http://edbl.net/internetspecial.html>



# Ceramic Container



**Name:** Ceramic Container

**Price:** \$1,490.00

**Menu #:** F2

**Quantity:**

**Maintenance:** Deep soak 2 - 3 times per week

**Water:** Deep soak three times per week. Irrigation included

**Prefab:** Yes

**Description:** includes perennial plant in ceramic container

Bio dynamic compost (1) bag

fertilizer organic Dr. earth, 3" crushed stone (drainage), (4) 1" fire

bricks gray - black or rust color, (4) bags organic soil,

delivery and installation. \$300.00 for ceramic container

**Options:** Plant greens, herbs, and or any vegetables as a raised bed.

**Note:** Click on our extended photo gallery and scroll to Pots and

Containers for more options.

**Link:** <https://ediblelandscapes.shutterfly.com/pictures/155>



# Decorative Cement Containers



**Name:** Twin Decorative Cement Containers

**Price:** \$1,690.00 Each or for (2) \$3,380.00

**Menu #:** F3

**Quantity:**

**Maintenance:** Deep soak 1 time per week

**Water:** Deep soak three times per week. Irrigation included to existing line.

**Prefab:** Yes

**Description:** includes agave, Russian sage, succulents,

Bio dynamic compost (1) bag

fertilizer organic Dr. earth, 3" crushed stone (drainage), (4) 1" fire bricks gray - black or rust color, (2) bags organic soil, delivery and installation.

**Options:** Plant greens, herbs, and or any vegetables as a raised bed.

**Note:** This quote is for one container. Two are shown in picture. Click on our extended photo gallery and scroll to Pots and Containers for more options.

# Blew's Blueberry Mini Tower Boxes



**Name:** Blew's  
Tower Boxes

**Price:** \$1,600.00

**Menu #:** F4

**Quantity:**

**Maintenance:** Deep soak 3 times per week

**Water:** Deep soak three times per week. Irrigation recommended

**Prefab:** Yes

**Description:**

\$250.00 Douglas fir recycled

**Mini Blueberry**

**\$40.00 Fertilizer**

**\$250.00 Blueberry bush**

**\$600.00 Carpentry**

**\$60.00 Sealer and or paint**

**\$50.00 Hardware**

**\$350.00 Deliveries**

**\$1,600.00 Total**

**Options: Ceramic Container – see picture below. Save \$300.00**

**Note: Save \$ on bulk order, deliveries, & bulk material.**





# Consultations Designs & Surveys



# Garden Coaching Consultation

**Name:** Garden Coaching Consultation

**Price:** \$350.00

**Menu #:** G1

**Description:**

**Note:** This consultation is a general overview of all content listed. We spend two or three minutes on each subject.

**Important:** You are welcome to have us focus on one area or another. Please inform us of this prior to the meeting.

**Preparation for Gardening Coaching Consultation:**

**Determine where meeting will be, Physically in person or via internet, zoom or other platform.**

**1) Look through pictures, menu's, on our website and see if there is anything there specific you would like to have incorporated on your property and perhaps onto your theme drawing. Email us the file name at the bottom of the picture.**

**2) Provide any pictures and or concepts/ideas you may have from the internet (links), books, magazines, scans, Pinterest etc.**

**3) Take a look at our [Create a Food Forest at Home](#). Email us your interest.**

**4) Check out [www.Alivewater.net](http://www.Alivewater.net) to understand a little bit about recommended water technology mimicking nature. Bottled water gone forever!**

**There's a lot of info we will share with in a short time. The goal is to get a general idea of your property-**

**theme drawing. From the theme drawing, we start with a chosen installation, one phase at a time.**

**We recommend you start small and that you will be interactively involved with your Edible Landscape learning what works best on your own property as far as maintenance, climate conditions, family involvement, and future installations.**

**Consultation is \$350 and Includes:**

- **Site visit**
- **Recommendations for appropriate garden project setting, size, design, and materials based on client's needs**
- **60 page consultation booklet**

**Consultation booklet includes:**

- **The importance of a plan and a design**
- **Vegetable garden standards designs/surveys/drawings and books**
- **Secrets of the soil, mulch and organic fertilizers**
- **Where to purchase your plants**
- **Vegetable yield**
- **When to plant certain vegetables-planting calendar.**
- **What you can start from seed**
- **When you can grow what**
- **Hardscape-what materials will you build your garden from?**
- **Animal and pest/disease control**
- **Maintenance-weekly, monthly...**
- **Water-how to water your garden with "living" water**
- **Irrigation options**
- **Resources-recommended installers, recycled materials, nurseries and**
- **Typical pit falls of the beginner**



**A 60 page booklet covering all of the above topics is provided to you via an on-line link.**

# Permaculture Consultation

**Always keep the big  
picture in mind!**

**Title:** Permaculture Consultation

**Price:** \$777.00 additional professionals ad in \$250.00 per professional-strongly suggested

**Name:** Permaculture Consultation

**Price:** \$777.00

**Menu #:** G2

**Description:** This is a survey of your vision, specifications, property data collection, history of property, neighbors, potential permits, multiple mind input, and many important details to consider as a starting point. There are many critical questions when considering an over all instllation. This meeting can be lengthy pending on the detail, & scope you give to your potential project.

**The Permaculture consultation:**

1. An over view of what permaculture is “The practice of sustainable human habitats by following nature's patterns”
2. Permaculture Design case Study
3. Reading The Landscape:
4. Suggestions

# Property Survey



**Name:** Survey

**Price:** \$1,500.00 +

**Description:** Measuring survey property, and or portion of property. Elevations can be taken also for water run off. Water source, electrical, compost, trash, communications, existing irrigation located. Theme Concepts drawing, landscape design, irrigation design locations, hardscape design, water retention/flow design, all follow survey.

**Menu #:** G3

**Quantity:**

**Maintenance:**

**Water:**

**Prefab:**

**Work hours:** 60hrs. + or – 1 week

**Options:** Google maps can some times be used for your survey.

**Note:** Surveys can vary in price, based mostly on detail . Visits to the property may be necessary through out the survey creation. Surveys can greatly vary in price pending on detail. A simple rectangular yard can





**take minutes to measure. However when trees, play sets, sheds, fountains, exist, then there is more to measure.**

# Theme & Concepts Design

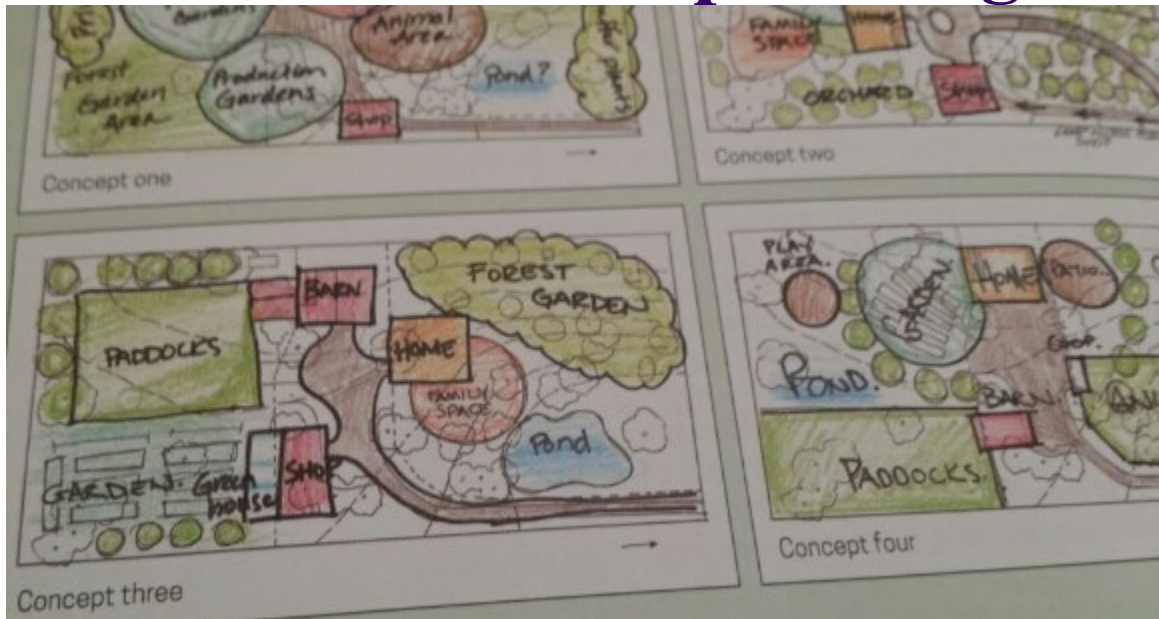

**Name:** Theme and Concepts Design

**Price:** \$1.290.00 +

**Description:** Theme drawing follows the survey or rough sketch of property. We have over 100 specific property items to choose from i.e. ponds, raised vegetable beds, food forests, scented forest, color themes, wind brakes, privacy, native planting, meditation rooms, living walls/roofs, and so on....

These items are listed and or placed on the Theme Concept Design Drawing roughly locating them in their potential positions. You may select maybe 10 items from this all important list that has been accrued over the the past 20 yrs, that we are continuously adding to. This is the client's opportunity to include from their wish list items of importance that left out could alter the entire design added in later. This drawing is part of thoroughly thinking through the over all installation, at the critical beginning phase. It is the beginning phase, and the foundation of the new design installation.

**Menu #:** G4

**Quantity:**

**Maintenance:**

**Water:**

**Prefab:**

**Work hours: 24hrs. + or – 2days**

**Options:**

**Note:** More then one designer usually participates. The premise of permaculture design is diversity mimicking nature. This is why we involve multiple designers with different strengths, back grounds, and years of experience, taking a holistic view of your property.

**Link:**



# Water Flow & Retention Design

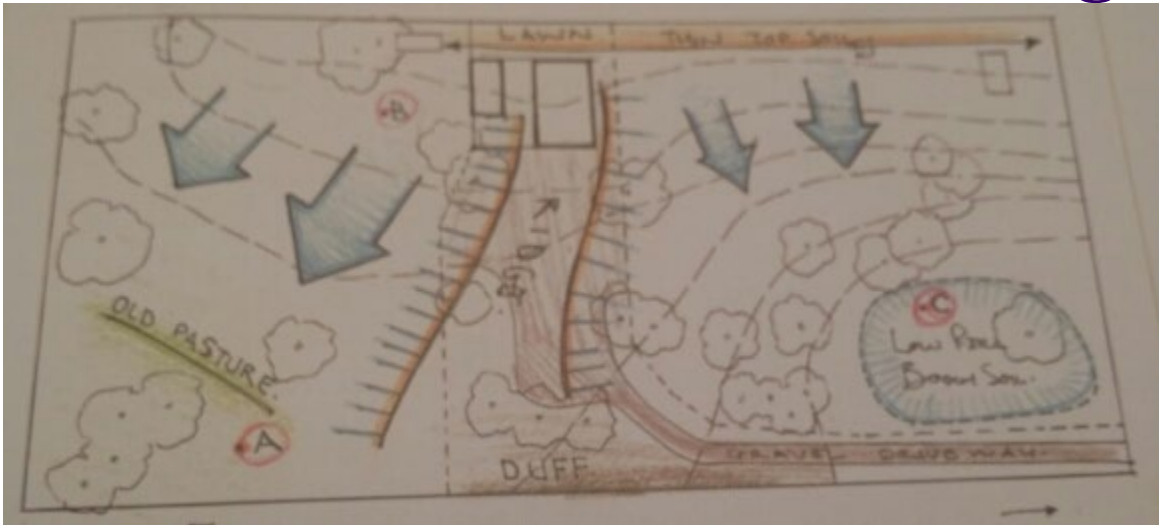

**Name:** Water Flow & Retention Design

**Price:** \$750.00 +

**Description:** Designing property elevations, taking water to catchment and retention absorbing water onto the property, rather than taking water away from property. This helps everything on the property flourish since water is what makes everything grow. Dry and wet creek beds, water falls, french drains, wine barrels, swales, terrises, and the like, help to keep water on property and prevent water run off. Water flow examined, documented and designed.

**Menu #:** G5

**Quantity:**

**Maintenance:**

**Water:**

**Prefab:**

**Work hours:** 25hrs. + or - .75 week

**Options:**

**Note:**

**Link:**

# Plant & Hardscape Design

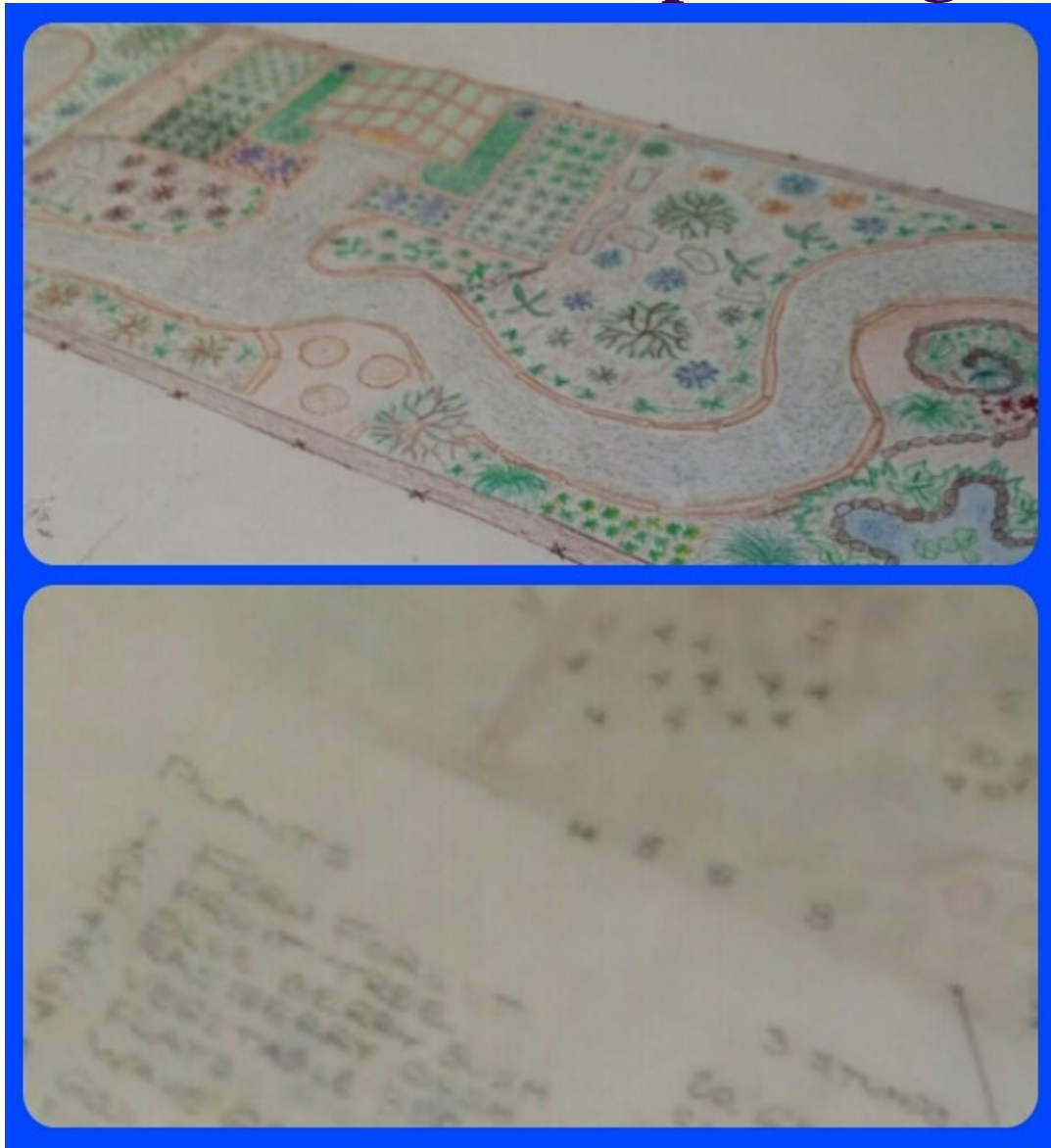

**Name:** Plant and landscape Design

**Price:** \$2,500.00 +

**Description:** Taking menu and or custom request pre-budgeted, and estimated selections from client, and creating plant and hardscape design. Each plant and hardscape is mapped numerically to legend. Drawings and designs are co-consented by designer and client, followed, and referred to through out the project. They anchor the project. Please read our project classifications stressing the importance of the design and following it. Within our project classifications are other options i.e. hourly rates with no design drawing. However, we are to be paid for

deconstruction, reconstruction should this occur if you decide to opt out on designs. From our experience, drawing designs play a critical role in a smooth running installation. We believe working without drawings is rolling the dice with everyone's energy.

**Menu #: G6**

**Quantity:**

**Maintenance:**

**Water:**

**Prefab:**

**Work hours: 70hrs. + or – 1.5 weeks**

**Options:**

**Note:** Visits to the property may be necessary through out the design creation

**Link:**



# Irrigation Design



**Name:** Irrigation Design

**Price:** \$1,700.00 +

**Description:** Irrigation plan follows plant design, locating irrigation heads, types of heads, diameter distances, overlapping, angles, heights, drippers, emitters, misting, piping, splitters, and computer controller location.

**Menu #:** G7

**Quantity:**

**Maintenance:**

**Water:**

**Prefab:**

**Work hours:** 70hrs. + or – 1.5 weeks

**Options:**

**Note:** Visits to the property may be necessary through out the design creation

**Link:**

# CAD Drawings & Designs



**Name:** CAD (Computer Aided Design) Drawings

**Price:** Ad 33% to hand drawing prices

**Description:** Computer Aided Design Drawings are generated from survey. They require skilled technicians to transfer drawing design details to digital screens for easy access at a later date. These drawings are easier to modify, store, and access from multiple different locations by multiple different people.

**Menu #:** G8

**Quantity:**

**Maintenance:**

**Water:**

**Prefab:**

**Work hours:** 70hrs. +

**Options:**

**Note:** Visits to the property may be necessary through out the design creation

# **Maintenance & Care**





# Fruit Tree Biodynamic Injection



**Price: \$1,027.00**

**Menu #: H1**

**Description:** 10 Fruit tree injections. With a bar, we create drill 1" holes 12" - 18" deep down into the roots of trees. We then insert compost and tea into the holes helping the tree receive nutrients. The result has always been astoundingly successful giving some times immediate buds, and fruit to trees that have "never" given fruit like the orange tree in the picture. Please request for references.

**Quantity: 10 fruit trees**

**Materials:** *70lbs Biodynamic Soil, 12oz. Super Thrive, 16oz. Kelp powder, mulch*

**\$135.00 Biodynamic Soil**

**\$14.00 Super Thrive**

**\$18.00 Kelp powder**

**\$210.00 (14) bags mulch on each tree, bagged or bulk**

**\$150.00 - \$250.00 pick up and deliveries**

**Maintenance:** *Yearly mulch and tea only*

**Water:** *On timer 2x's per week pending on season*

**Work hours:** *16hrs (2) workers (1) day*

**\$500.00**

**Note:** *We will make a (5) 5gal teas to pour over each tree when through at end of day. Each tea will have included: biodynamic compost, super thrive and kelp, to help boost immunity of each tree.*

# Tree Transplanting



**Name:** Tree Transplant

**Price:** \$4,500.00

**Description:** “Undisturbed” root system transplant 40” ball larger or smaller. Transplanting is a skilled delicate process. We carefully trench around the tree, then weave burlap around it holding it tight preventing cracking of the ball. We replant the tree with  $\frac{1}{2}$  native soil,  $\frac{1}{2}$  top soil and 351lbs bio dynamic soil.

**Menu #:** H2

**Quantity:**

**Maintenance:** Watering

**Water:** On timer 2x's per week pending on season

**Work hours:** 150hrs (3 - 6) workers (5) days





# Biodynamic Compost

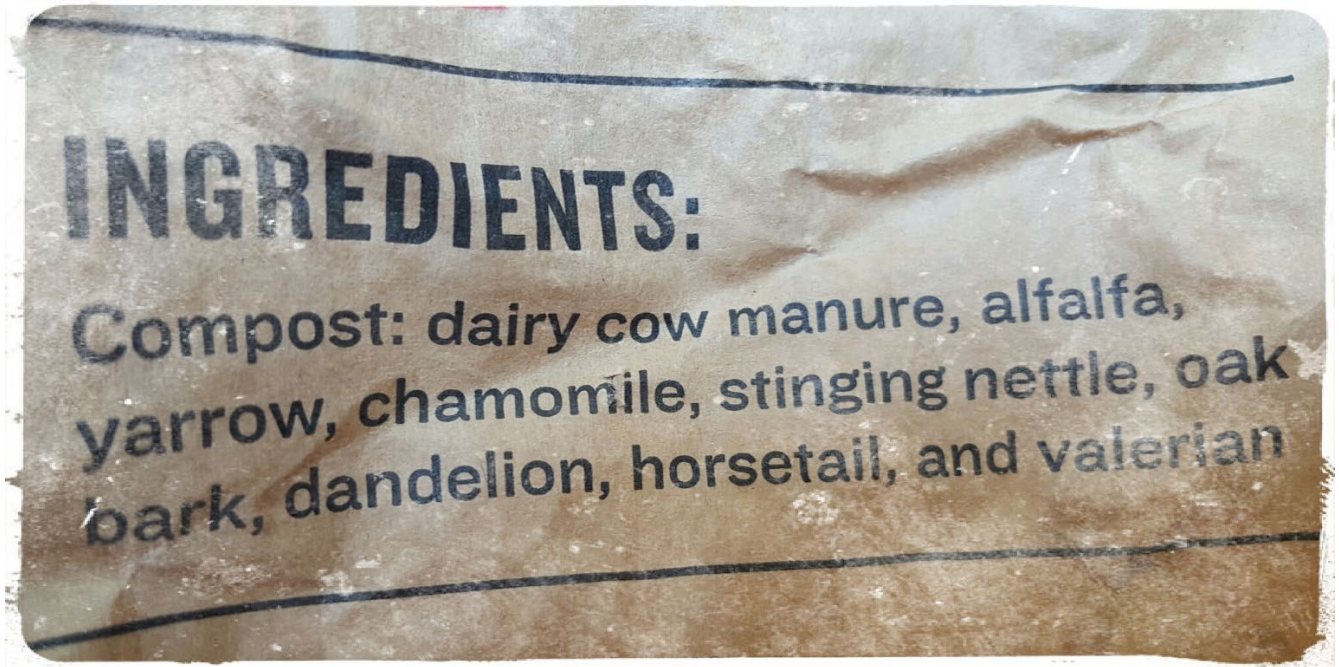

**Name:** Biodynamic Compost

**Price:** \$90.00 \$35/lb bag

**Description:**

**Menu #:** H3

**Quantity:**

**Maintenance:**

# Soil, organic mix, mulch



**Name:** Soil, standard compost - seed topper, mulch

**Price:** \$275.00 - \$350.00 per cubic yard delivered

**Description:**

**Menu #:** H4

**Quantity:**

**Maintenance:**

**Water:**

**Work hours:**

**Note:** Prices vary from location to location and amount purchased. (3) yrd. Minimum delivery

**Work hours:** 2 weeks

**Options:** We can build it using recycled Douglas fir



# Maintenance & Harvesting



**Name: Maintenance & Harvesting**

**Price: \$600/Month**

**Description Typical Maintenance:**

- 1) Mulch 2-3x's/yr
- 2) Water every 3 days "deep soaking" to roots with wand-more in summer 4 days/wk
- 3) use shower nozzle wand for watering
- 4) Clip greens from the outside
- 5) Fertilize 2x's/yr.
- 6) Diatomaceous earth sprinkled
- 7) Linseed oil application on wood where necessary
- 8) Possible sun filter canopy above garden during hot summer if exposed to direct sun light and temperatures above 95 degrees

**More detailed list included with consultation**

**Menu #: H5**

**Note: Prices vary from location to location, travel time, & size of garden**

**Work hours: 1.5 hr. per visit**

# Raw Living Vegan Culinary



**Heaven Balls**





**Name:** Raw Living Gourmet Food Prep

**Price:** \$100.00/ hr per chef \$800 per day per chef

**Description:** Garden to table. Collecting as much as possible from the garden. Variety of dishes, Avaghetti, salads, heaven balls, desserts, smoothies, mach tuna, proteins, cultured vegetables, herbal sun teas, appetizers, juicing, and all kinds of creative dishes

**Menu #:** J1

**Note:** Prices vary from location to location and amount purchased. Minimum ½ day \$400.00 per chef unless we are gardening on site. Price will then be established.



# **‘Live’ Garden Party Music**

**Quantum Hitch-hikers  
Since 08.08.08 Malibu Inn**



**Name: Live Music Entertainment**

**Price: \$1,700.00 1.5hr. show**

**Description: Unplugged acoustic set. Amplified**

**Menu #: k1**

**Fun festive and for all ages celebration life, nature.**

**Tommy Teeple – 70+ songs recorded**

**Todd Tragar – Composer, original guitarist from Dog logic**

**Danio – Few hundred original songs**

## **Gig list history:**

**Topanga Days**

**Malibu Inn**



**Farmers Markets**  
**Gardens of Gratitude Garden Bash**  
**Private Parties**  
**131 Topanga**  
**Corazone Topanga**  
**Earth Day Topanga**

**And the list goes on, hundreds of shows**

**Song samples:**

**Watch "Savory" Live at the Un-Urban Cafe**

<https://www.youtube.com/watch?v=dmg7JPrq2lw>

Watch "TeepleTV "Garden Girls" written & composed by Tommy Teeple" on YouTube

<https://youtu.be/QqKvfQD1ebk>

Watch "Teeple TV Butt Rub'n By: Tommy Teeple & The Quantum Hitch-hikers" on YouTube

[https://youtu.be/\\_ZLp8ThRppM](https://youtu.be/_ZLp8ThRppM)

**Watch "TeepleTV "Over Myself" (Happy) written & composed by Tommy Teeple" on YouTube**

<https://youtu.be/3HPAy0I-YgU>

Watch "WHAT'S WITH THE SKY? (click on all links) Calling My Friends" on YouTube

<https://youtu.be/H4CSxrnlAiU>

Watch "Hit Me With Your Love By Tommy Teeple Teeple-Records" on YouTube

<https://youtu.be/daWNV0QpJ88>

Watch "So Lost (and I love it.).mov" on YouTube

[https://youtu.be/oIW\\_vt95IOU](https://youtu.be/oIW_vt95IOU)

# Your Brain On Nature



## Eco-therapy

**“Of all the paths you take in life  
make sure that some of them are dirt”**

**John Muir**

*It's been over 25yrs now since the birth  
of Edible Landscape*

*Nature has become a rock in my life,  
never deviating and always there for  
me in my good times & not. Healing,  
rejuvenating, & comforting*

*As a service to you, I, Tommy & we offer  
shared activity in nature.*



## **“Nature Immersion”**



**Name: Nature Immersion – Your Brain On Nature**

**Price: \$250.00/hr - \$400.00 ½ day**

**Description: Connecting with nature**

**Menu #: J1**

**Research shows that to actually show one cares about nature, one must have actually be exposed to it. Natural environments offer unbelievable benefits for our health.**

**Choose from:**

- 1. Gardening**
- 2. Forest hike - Vitamin G**
- 3. Natural fire hangout**

4. Natural site seeing, permaculture sites
5. Outdoor education, sharing recommended reading, work books
6. Outdoor uninterrupted listening
7. Beach with outdoor play
8. Wilderness activity - bare foot hiking, earthing, journaling in nature
9. Music in nature
10. Creativity in nature. Let it come through. All of us are creative
11. Discussion & direction on outdoor careers
12. Study of local natural plants
13. Awareness - Study of the harmful affects of modern living, technology, current day
14. Natural building, working with cob for example
15. Discussion on societal current day status. Solutions on how to heal from it, and positive ways to overcome the impossible
16. Relationship University, Quantum Hitch-hiker, & other documentation. Literature written & shared by Tommy
17. Book recommendations. These naturally come up on nature excursions and sessions
18. Outdoor workouts
19. Eventually become immersed in nature yourself helping others along the way, like I do now.
20. Rock hopping
21. Incorporating walking into one's life
22. Forest air bathing
23. Wilderness therapies
24. Indoor plants & water features
25. FUN

The goal is to assist interested individuals in crossing the bridge from the modern world back to the natural world. I ,Tommy am here to help you cross that bridge with baby steps, then eventually, you can walk on your own. Then you will guide others across this bridge.

We, together, will create a more natural life style.

*“Nature is always lovely, invincible, glad, whatever is done and suffered by her creatures. All scars she heals, whether in rocks or water or sky or hearts.”*

*John Muir*



*Painting From Larry, Tommy's Mechanic*













Gratitude & inspirational thank you's to Robert G. Becker,  
permaculture villages/movements, & all the Edible Landscape  
clients over the past three decades

**Thank you for your wonderful visit.**  
Wishing you, nothing but your natural dreams come true....



Let all life's beautiful gifts, come to, and through you  
effortlessly..

In **God Given** Nature, *Tommy Teeple*